



Packaging Vents

D6 MOLDED COMPONENTS

D6 Molded Components for Containers from 0.2 – 2.0 l

HOW DO GORE® PACKAGING VENTS WORK?

GORE® Packaging Vents offer the best combination of liquid resistance and airflow through the use of expanded polytetrafluoroethylene (ePTFE). The material's microporous nature allows airflow and equalized pressure, even after contact with high viscosity or low surface tension liquids.

DESCRIPTION

Unique plastic molded component is engineered with durable ePTFE membrane and is designed to easily press fit into a wide variety of packaging systems. Unlike other horizontal vents which allow challenging fluids to block airflow, the D6 design has an angled membrane allowing the force of gravity to pull liquid away. In addition, the membrane is flush mounted to avoid the trapping of liquid in tight corners.

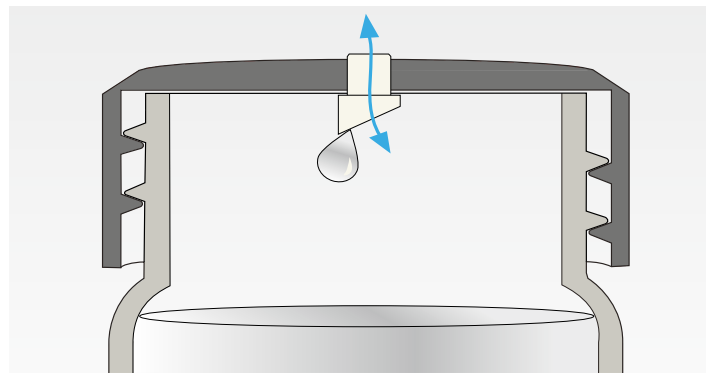

This particular design is optimized to allow airflow through the membrane after contact with very high viscosity liquids.

TYPICAL APPLICATIONS

GORE® D6 Molded Components are often used to:

- Prevent container distortion and/or
- Reduce container wall thickness

Typical applications include:

- Laundry detergents
- Household cleaners and disinfectants
- Household pesticides and fertilizers
- Household chemicals
- Bleaches
- Peroxide based formulations

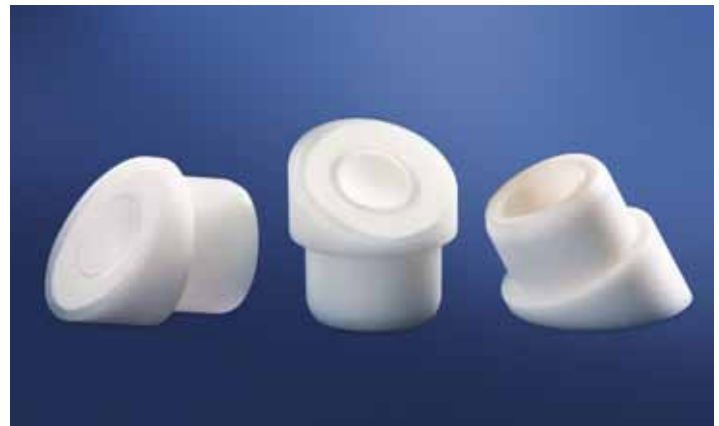

REALIZE THE BENEFITS OF GORE® D6 MOLDED COMPONENTS:

- **Equalize pressure** to prevent containers from bloating or collapsing without leaking
- **Enable the use of thin-walled, light-weight packaging**
- **Excellent resistance** to penetration of low surface tension liquids
- **Optimal design for applications requiring airflow** after contact with high viscosity liquids – liquid “rolls off”
 - Angled membrane surface
 - Flush mounted membrane
- **Compact size** fits into small containers, caps and dispensing devices
- **Ideal for high-speed, automated, friction-fit assembly**

D6 Molded Components	
Membrane	Oleophobic ePTFE
Plastic Material	Polypropylene (PP)
Water Entry Pressure	> 0.34 bar
Typical airflow at $\Delta p = 12$ mbar	0.42 l/hr
Part Number	CMF300261



Packaging Vents

D6 MOLDED COMPONENTS

INSTALLATION

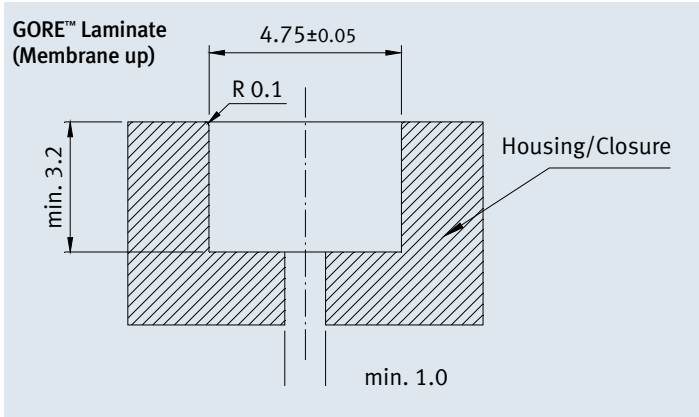

Samples of GORE® Molded Components are available for immediate shipment, to assist you in testing their suitability for your specific application.

D6 MOLDED COMPONENT

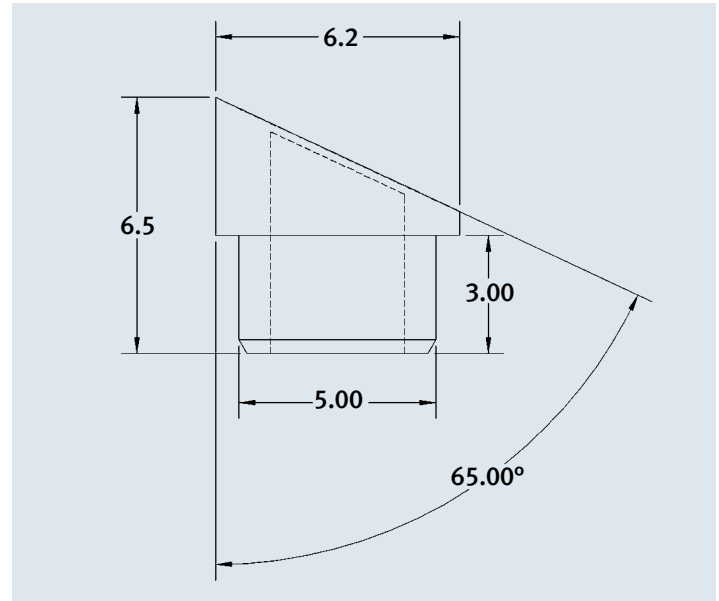

THE SCIENCE BEHIND THE SOLUTION

GORE® Packaging Vents offer an ideal combination of liquid resistance and airflow through the use of expanded polytetrafluoroethylene (ePTFE). They prevent liquid penetration, while allowing airflow and equalizing pressure, even after contact with low surface-tension liquids such as surfactants and solvents. When splashed by a viscous liquid, the membrane quickly recovers its venting capability.

For assistance in determining the best GORE® Packaging Vent for your application, or for help in validating your packaging design contact a Gore sales associate.

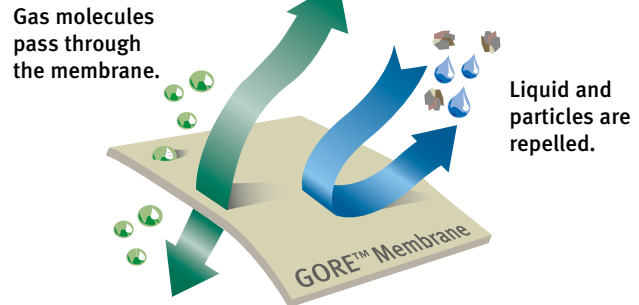

GORE® PACKAGING VENTS BREATHE WHILE REPELLING LIQUID AND PARTICLES.



REG. No. 288491
by W. L. Gore & Associates GmbH
is certified according to
DIN ISO 9001:2000

INTERNATIONAL CONTACTS

Australia	61.2.9473.6800	Mexico	52.81.8288.1281
Benelux	49.89.4612.2211	Scandinavia	46.31.706.7800
China	86.21.5172.8299	Singapore	65.6733.2882
France	33.1.5695.6565	South America	55.11.5502.7800
Germany	49.89.4612.2211	Spain	34.93.480.6900
India	91.22.6768.7000	Taiwan	886.2.8771.7799
Italy	39.045.6209.240	United Kingdom	44.1506.460123
Japan	81.3.6746.2572	USA	1.410.392.4440
Korea	82.2.393.3411		

W. L. Gore & Associates, Inc.

401 Airport Road • P.O. Box 1550 • Elkton, MD 21922-1550 • USA
Phone: 410.392.4440 • Toll-Free: 800.637.4449 • Fax: 410.506.8749 (US)
Email: packvent@wlgore.com

gore.com/packvents

FOR INDUSTRIAL USE ONLY. Not for use in food, drug, cosmetic or medical device manufacturing, processing, or packaging operations.

All technical information and advice given here is based on Gore's previous experiences and/or test results. Gore gives this information to the best of its knowledge, but assumes no legal responsibility. Customers are asked to check the suitability and usability in the specific application, since the performance of the product can only be judged when all necessary operating data are available. The above information is subject to change and is not to be used for specification purposes.

Gore's terms and conditions of sale apply to the sale of the products by Gore.

GORE and designs are trademarks of W. L. Gore & Associates
© 2011 W. L. Gore & Associates, Inc.

